

# Tequesta Trace Complex

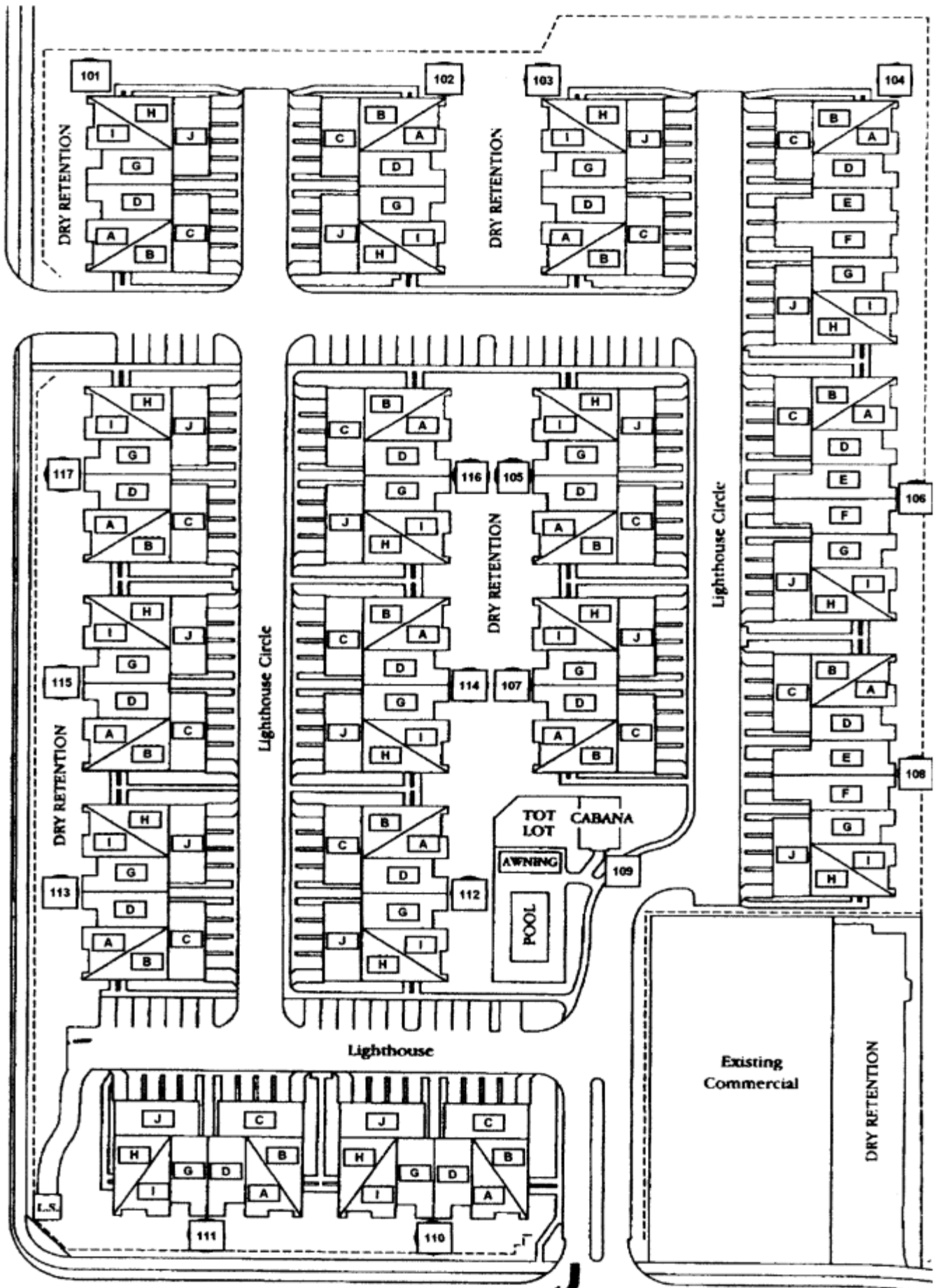

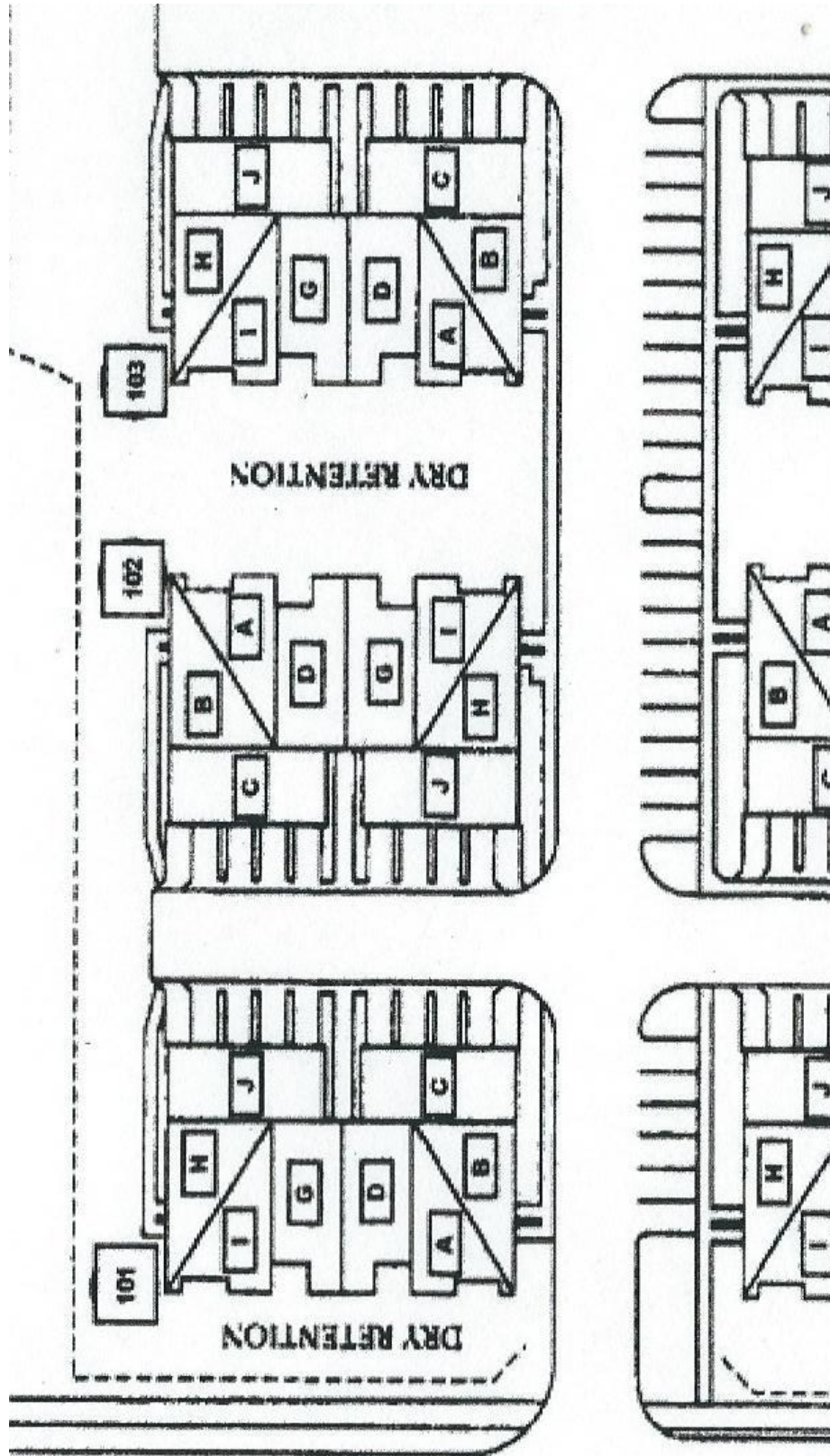

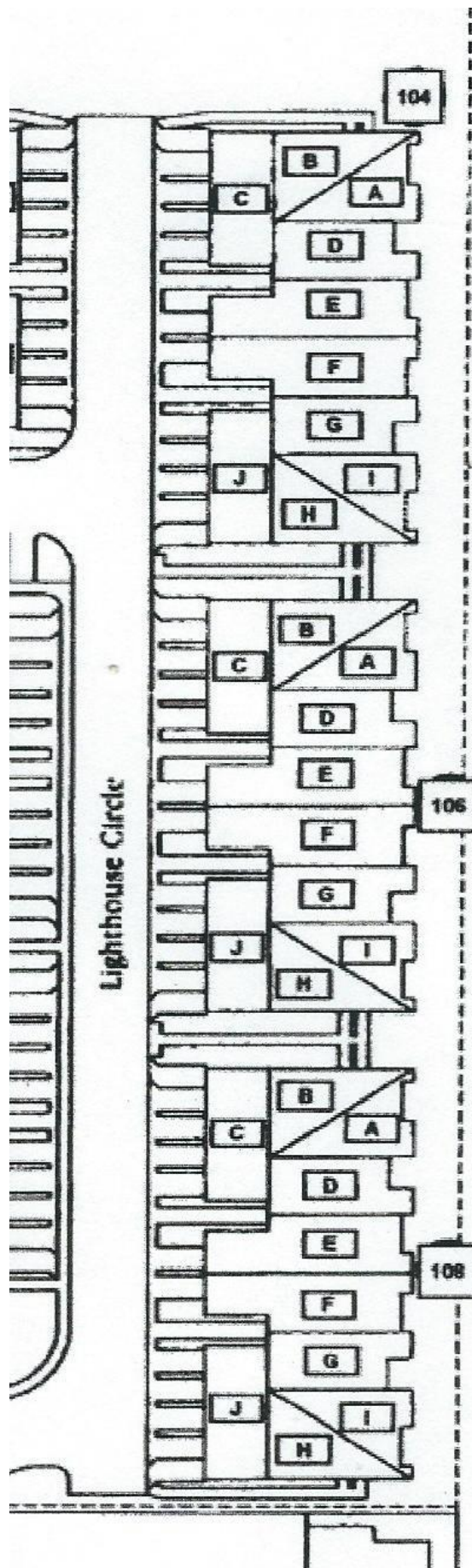

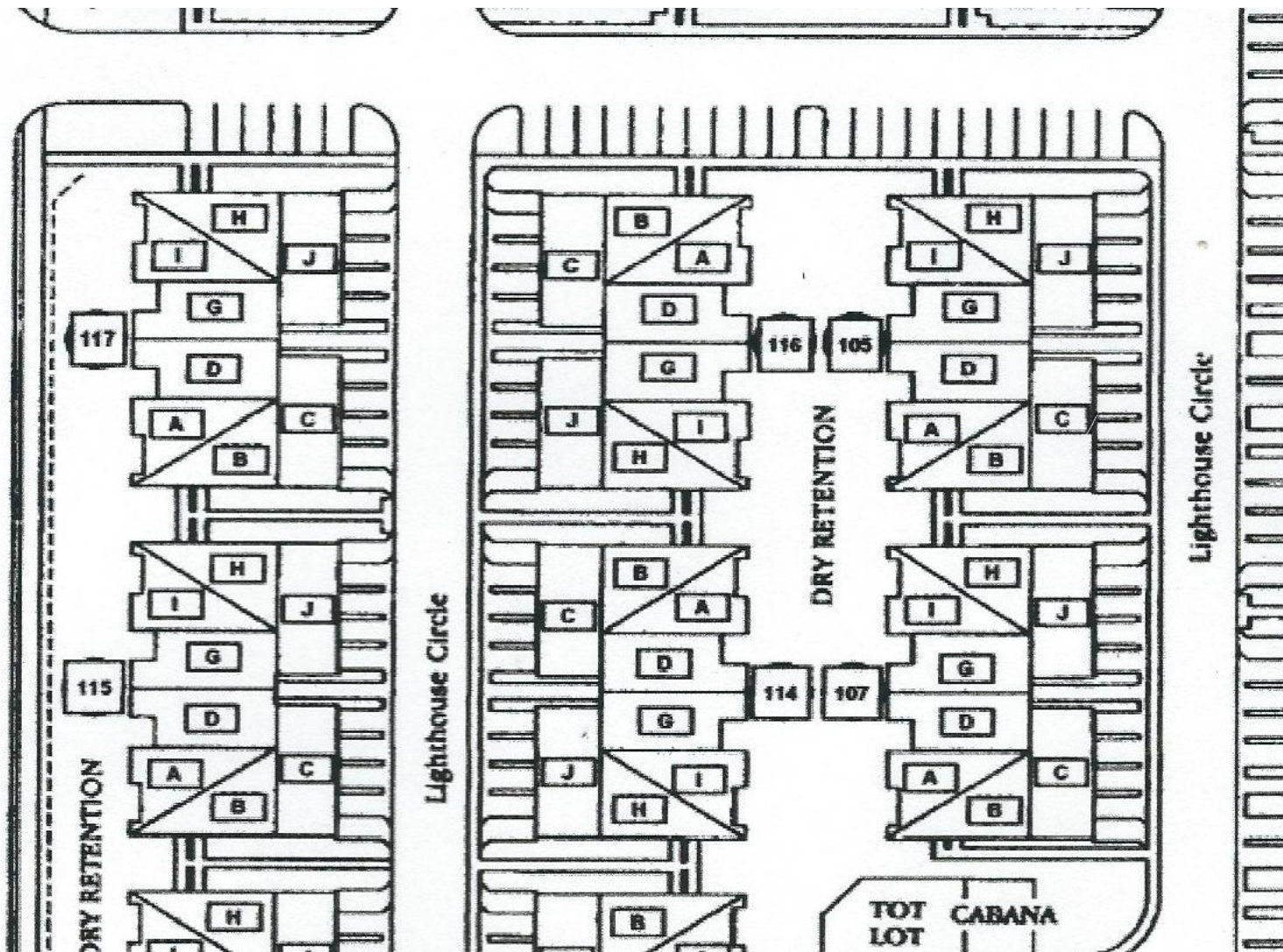

109, 112 - 113

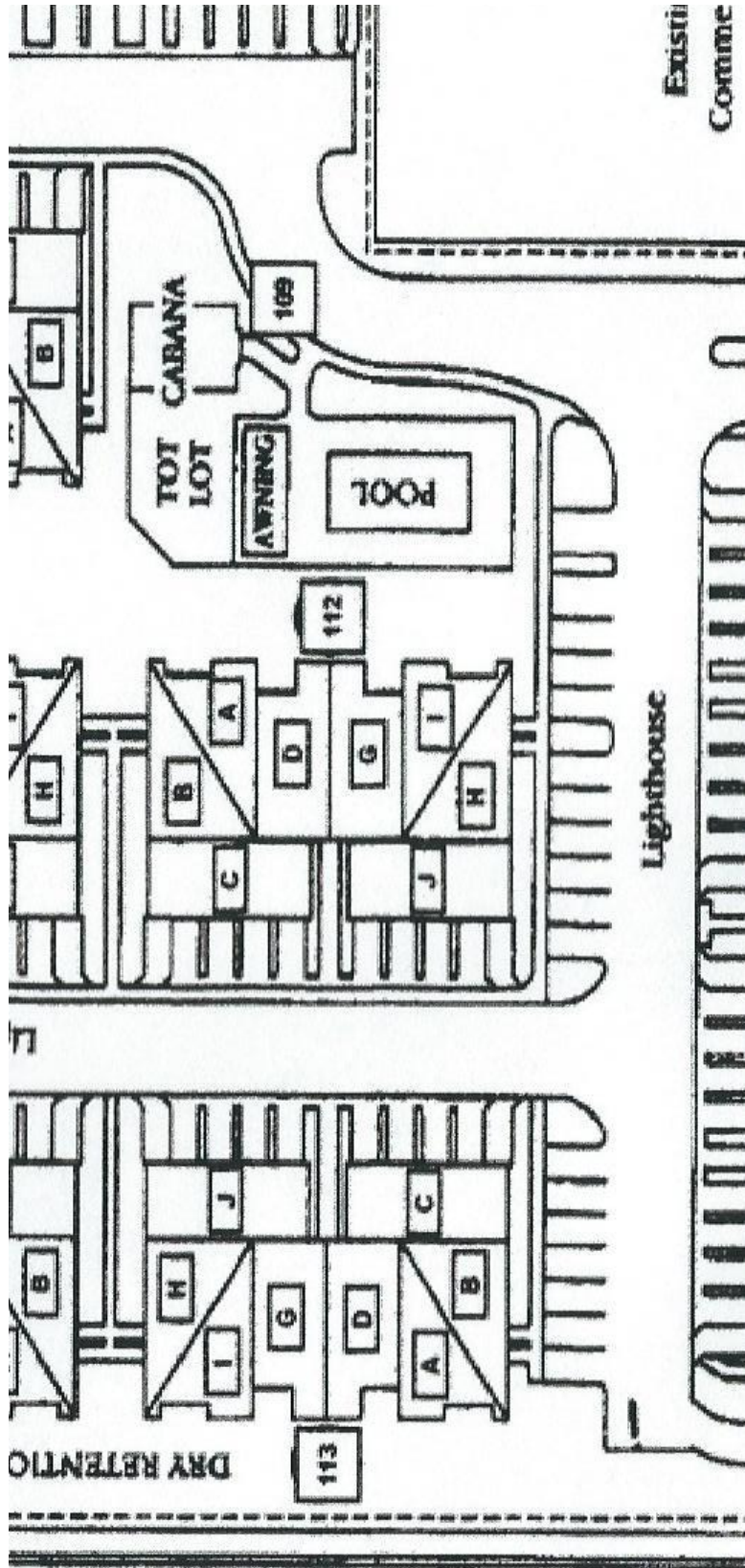

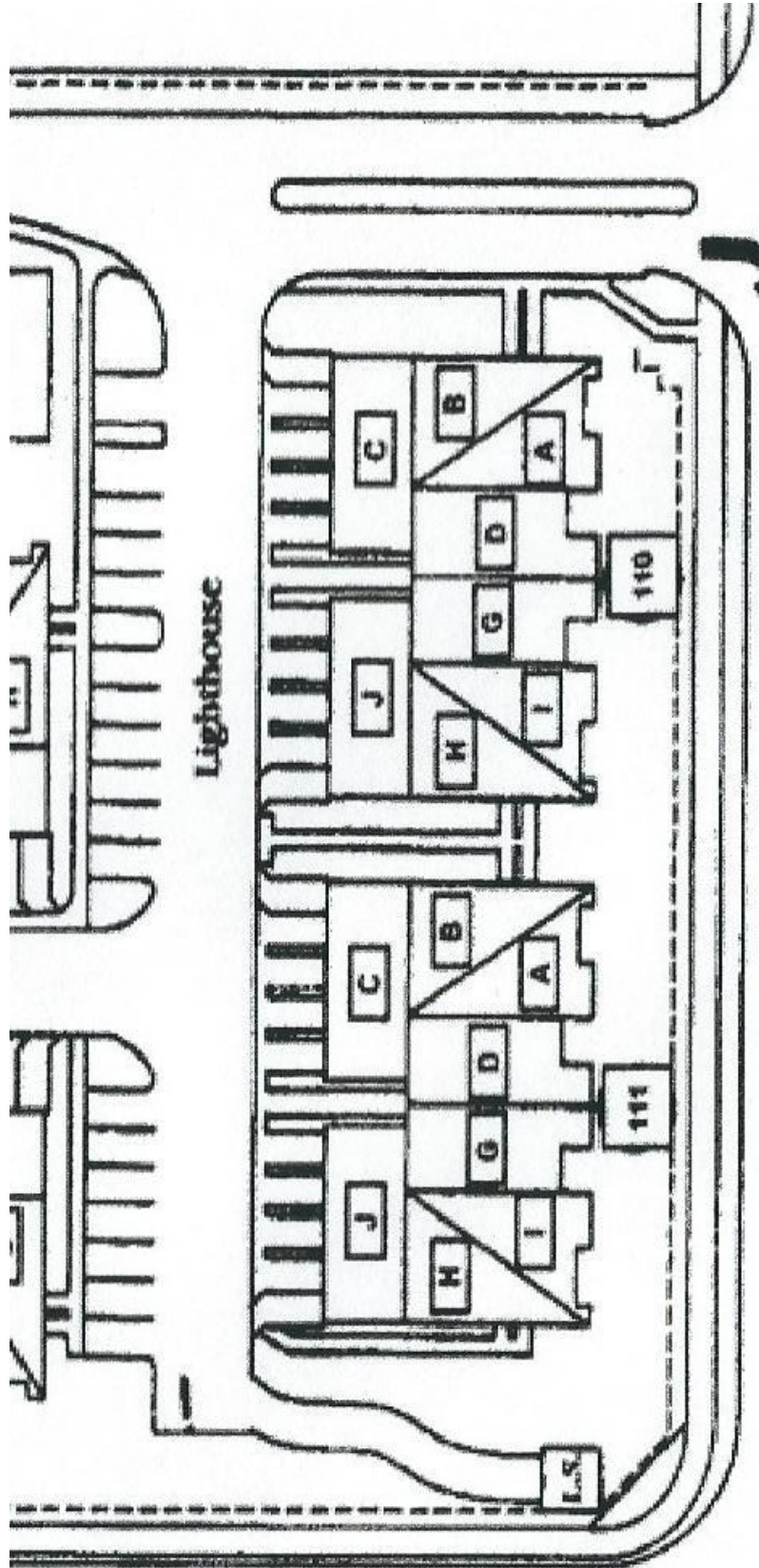

## Plantings

<u>Type</u>	<u>No.</u>	<u>Name and size</u>	<u>Quantities</u>	<u>Locations</u>	<u>Scratch through indicates change &amp; Red indicates additions/changed</u>	
Grass:	1	Palmetto <b>4 pallets behind</b>		101 Back	<b>&amp; 101-C</b>	
	2	Palmetto <b>2 pallets between</b>		104-E&J, 106 C,	<b>D&amp;F, 107-G, 108-J, 112-114, 114-C, 115-C, 116-J, 117-I</b> back	
Plants:	1	Arboricola Trinnette #3				
	2	Green Island Ficus #3				
	3	Firecracker #3	<b>4</b>	<b>Always being trimmed, not flowering &amp; 2 each at ends of streets</b>		
	4	Ilex Schillings #3				
	5	Fern #3	<b>40</b>	<b>40 Behind 104 two spots (30 + 10)</b>		
	6	Jasmine Minima 4"		<b>Retainer Area by hedge –Fertilize (will hit again today)</b>		
	7	Sword Fern #1				
	8	Xanadu #3				
	9	Lantana <b>Yellow-orange</b>	<b>50</b>	<b>5 @ 10 multiple locations at ends of buildings but not at street corners</b>		
Bushes:	1	Ixoria	<b>10</b>	<b>10 Insert a few around complex</b>		
	2	Plum Bagos		Not good - Scales and fungi		
	3	Hybiscus		Not good – bugs, and leaves fall		
	4	Azelia		Not good – needs acidic soil like up north		
	5	Cortin Green yellow spots	<b>10</b>	<b>10 Insert a few around complex</b>		
	6	Wondering Juniper #3	<b>61</b>	<b>7 101-I, 7 102-A, 7 108-I-J, 20 110-111, 20 113-115</b>		
	7	Indian Hawthorn #3	<b>9</b>	<b>3 Pool corner Island, 3 by 109, 3 by 110</b>		
	8	Ilex schillings #3	<b>3</b>	3 by #116 unit A		
	9	Arboricola trinnette #3	<del>67</del> <b>72</b>	10 104-C, 2 106-C, 5 106-D, 2 106 -G, 5 108-D, <del>10</del> <b>6</b> 108- J, 8 104-J, 2 110-G, 3 111-D, 2 111-G, <b>3 112-C, 10 114-C, 2 114-G, &amp; 6 4 116-J</b>		
		Arboricola trinnette #3		<b>6 109 (Hedges at Cabana 3 north &amp; 3 east side)</b>		
10	<b>Anti Lou Tai (Maroon)</b>	<b>7</b>	<b>One each at 101-G, 104-D&amp;E, 107-G, 113-D&amp;G, 115-G</b>			
11	<b>Gold Capploa</b>	<b>10</b>	<b>10 Pool corner island area hedge inserts 5 west and 5 south ends</b>			
Trees:	1	Bougounuilleate		Not good for our complex, needs a large open space to grow		
	2	Hybiscus		Not good – bugs, and leaves fall		
	3	Crepe Myrtle				
	4	Rubalini palms				
	5	Star Burst				
	6	Jatropha std. #25	<b>1</b>	1 between Pool & 108 next to south side wall		
	7	Cocoplum #7				
	8	Areca Palm				
	9	<b>Lugustrue</b>	<b>3</b>	<b>Trees by A/C at end units 1 105-A, 1 114-A, 1 116-I</b>		
Edging:	1	black plastic edging - <b>500'</b>		<del>800'</del> <b>500'</b> plus labor behind 105-116 & 107-114 (crescent shape)		
	2	black plastic edging - <b>350'</b>		<del>500'</del> <b>350'</b> plus labor between 102-103 (crescent shape)		
	3	black plastic edging – 130'		<del>120'</del> <b>130'</b> building 110-C-A <del>120'</del> <b>add by 110 wall end 10'</b>		
	4	black plastic edging - <b>31'</b>		<b>31'</b> Pool corner island area 31'		
	5	black plastic edging - <b>35'</b>		<b>35'</b> Building 107-105		
Erosion Control						
	1	<b>1-Catch box &amp; 75' pipe</b>		Behind 106, 1 small PVC catch basin with 75' 4" PVC buried to existing culvert		
	2	<b>By others</b>		Open existing culvert to accept 4" PVC pipe		